



## BEARING REMOVER

BBB BOTTOM BRACKET TOOL  
/BTL-232/233

BBB CYCLING.COM  
ROOSEVELTSTRAAT 46, 2321 BM  
LEIDEN, THE NETHERLANDS

EN MANUAL / DE HANDBUCH / FR MANUEL / NL HANDLEIDING / ES MANUAL / PT MANUAL /  
IT MANUALE / HU HASZNÁLATI UTASÍTÁS / PL PODRĘCZNIK / CZ UŽIVATELSKÁ PŘÍRUČKA  
/ JP 使用説明書 / RU РУКОВОДСТВО ПОЛЬЗОВАТЕЛЯ / SK MANUÁL / NO HÅNDBOK



FIND YOUR TRANSLATION  
AT BBBCYCLING.COM



### WARNING

Sold only by professional bicycle dealers.  
For proper installation, ask your BBB dealer.  
Not following the instructions in this manual may  
cause damage to the product not covered under  
warranty, damage to the bicycle, or cause an  
accident resulting in injury or death.

### COMPONENTS:

- 1 DRIVER BOLT
- 2 EXTRACTOR CUP
- 3 EXTRACTOR PLATES

### BTL-232

M8  
37 MM  
22 & 24 MM

### BTL-233

M8  
42 MM  
29 & 30 MM

### TOOL ASSEMBLY:

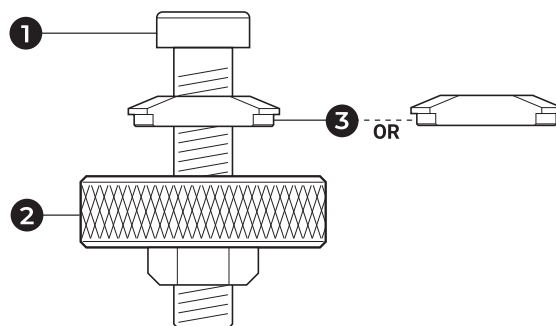

## ENGLISH

### BEARING REMOVAL

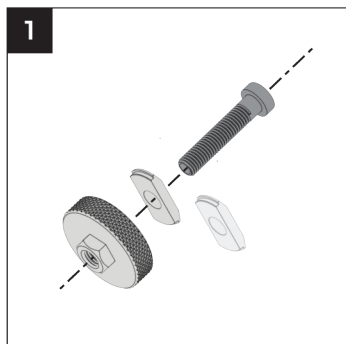

Assemble the tool by placing the correct extractor plate matching your bearing on the driver bolt, followed by the extractor cup.

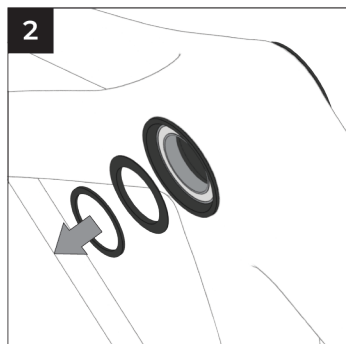

Make sure to remove any spacers or bearing shield so that the bearing is clear of any obstruction.

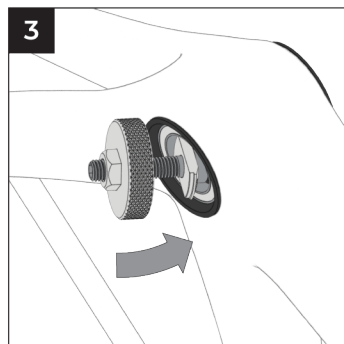

Place the tool at an angle inside the bearing, then make sure the extractor plate is properly seated behind the bearing.

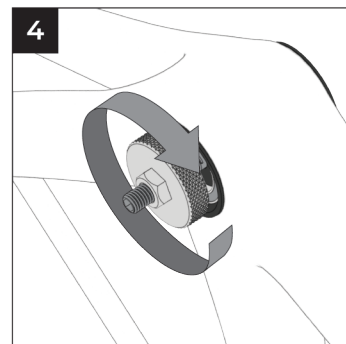

Tighten the extractor cup by hand while holding the driver bolt till the cup is flush against your bottom bracket or frame.

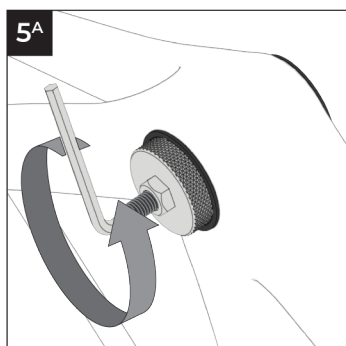

Place a 5mm Allen key on the driver bolt and turn it counterclockwise while holding the cup to extract the bearing from the bottom bracket.

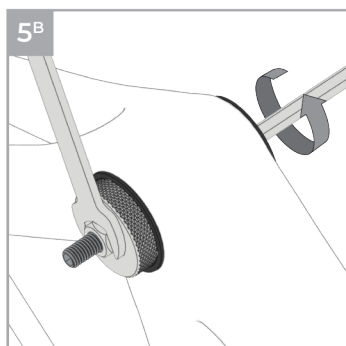

To easily apply more force **if the bearing is seized**, use a 17mm open spanner on the extractor cup and a long 8mm allen key from the inside on the driver bolt.

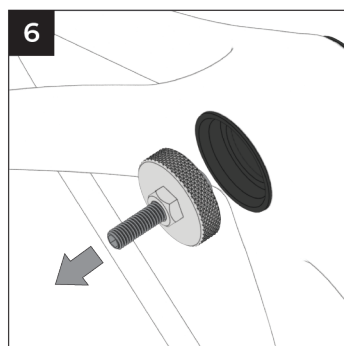

Once the tool and bearing feel loose, remove the tool. The bearing is now properly extracted.

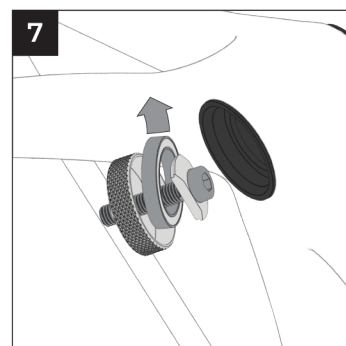

Proceed by removing the bearing from the extractor cup, and repeat step 2-7 on the other side.