

BATTERY & CHARGER

FOR JAM² 7-SERIES

ORIGINAL USER GUIDE
ENGLISH

Version 2 | 18.08.2022



BATTERY & CHARGER

FOR JAM² 7-SERIES

***DEAR
CUSTOMER***

This user guide contains information on how to operate and care for your battery and its charger. Read this guide and all of the safety instructions carefully through before charging for the first time and retain the guide for future use.

1. SAFETY INFORMATION

WARNINGS

SERIOUS INJURY DUE TO INCORRECT OPERATION.

People (including children) who are unable to use the battery and charger because of their physical, sensory or intellectual capabilities, or because of their lack of experience or knowledge, are prohibited from using them unless supervised or under the instruction of a responsible person.

SERIOUS CRUSHING INJURY DUE TO ACCIDENTAL ACTUATION OF THE ON BUTTON.

Remove the battery before making any settings to, or cleaning or transporting the Pedelec.

SEVERE BURNS DUE TO EXPLOSIONS AND/OR FIRE.

- Only use your bicycle with the original battery that it came with.
- Only charge the battery using the original approved charger.
- Do not use or charge a damaged battery. Never transport a damaged battery by yourself, or allow a commercial third party to do so. Get in touch with your specialist workshop.
- Do not use the charger if you notice any damage. Inspect the housing, cable and connector before each use.
- Keep batteries away from excessive heat (such as fire, radiators, direct sunlight).

- During charging, ensure that there is sufficient ventilation, and never place the battery or charger close to or on combustible materials (e.g., paper, textiles, etc.). This also applies when the battery is charged when fitted to the Pedelec. In this case, the Pedelec must be positioned in a way that a potential fire cannot spread quickly (exercise caution with carpeted floors).
- The charger and battery may not be covered during the charging process.
- Never leave batteries to charge unattended.
- Do not open up the battery or charger.
- Do not store batteries where they can be short-circuited by contact with each other or with conductive materials (screws, paper clips, keys, coins, nails or other small metal objects).
- Do not expose batteries to mechanical shock, as this may damage them.
- If the battery emits smoke, it should – if this is still possible – be taken out into the open air, and ideally, allowed to burn out in a sandbox. Be careful not to inhale the smoke and call the fire brigade.
- The charger is only intended for indoor use. Keep the charger away from rain and moisture. Only use on a dry surface. If water has penetrated the casing, unplug the device immediately and have it checked out in a specialist workshop.

⚠ CAUTION

MINOR INJURIES DUE TO DAMAGE OR INCORRECT OPERATION.

- Vapours emitted from the battery can irritate the respiratory tract. Ensure that there is a supply of fresh air and consult a doctor in case of any discomfort.
- If fluid leaks from the battery and comes into contact with your skin, it can irritate your skin. Wash the fluid off with water. If battery fluid gets into your eyes, rinse your eyes with plenty of water and seek additional medical attention.

PLEASE NOTE

DEVICE DAMAGE DUE TO OVERVOLTAGE.

Batteries are subject to the dangerous goods regulations. Private users are permitted to transport them on the road without further conditions. Special packaging and labelling requirements must be observed when transported by commercial third parties (e.g. by air, freight forwarders and logistics firms). Please contact your cycle dealer if you have any questions about transportation.

2. TECHNICAL DETAILS

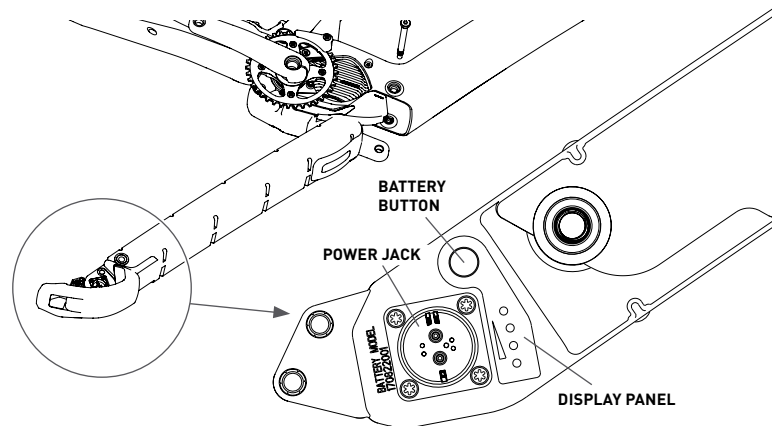

BATTERY

Part numbers _____ 170822001 | 10INR22/71-4
Nominal voltage _____ 36 V
Nominal capacity _____ 19.6 Ah
Power _____ 720 Wh
Permissible ambient temperature in operation _____ -10°C - 40°C
Permissible ambient temperature when charging _____ 0°C - 40°C
Permissible ambient temperature in storage _____ 0°C - 20°C
Weight approx. _____ 4 kg
Protection class _____ IPX5

2. TECHNICAL DETAILS

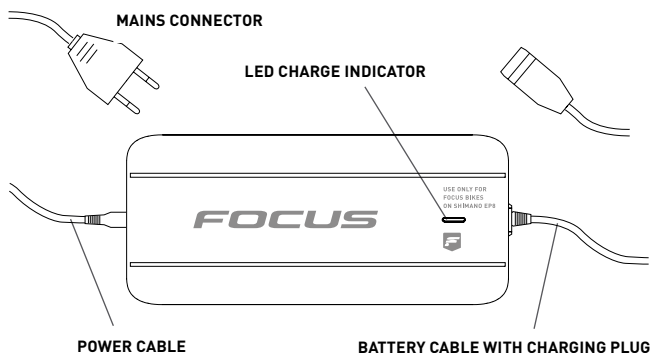

CHARGER

Part number _____ BC222360040
Nominal voltage _____ 90 - 240 V
Frequency _____ 50/60 Hz
Battery charging voltage _____ 42 V
Charging current (max.) _____ 4 A
Charging time (approx.) _____ Approx. 5 h
Permissible ambient temperature when charging _____ 0°C - 40°C
Permissible ambient temperature in storage _____ -20°C - 65°C

3. BATTERY



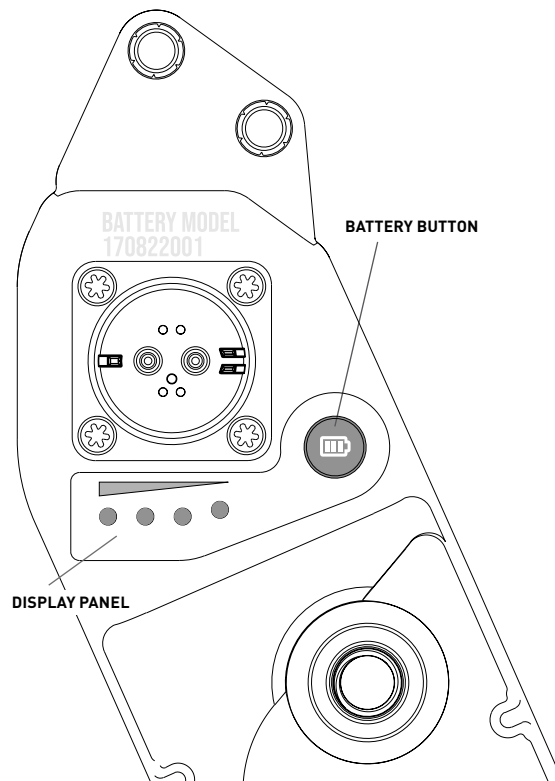

DISPLAY PANEL AND BATTERY BUTTON

When you press the battery button, the number and type of lights will give you information about the state of the battery.



3.1 CHARGING STATE

Briefly press the battery button in standby mode.

DISPLAY	DESCRIPTION	CHARGE LEVEL
	4 LEDs light up	80 – 100%
	3 LEDs light up	60 – 80%
	2 LEDs light up	40 – 60%
	1 LED lights up	20 – 40%
	1 LED flashes	0 – 20%

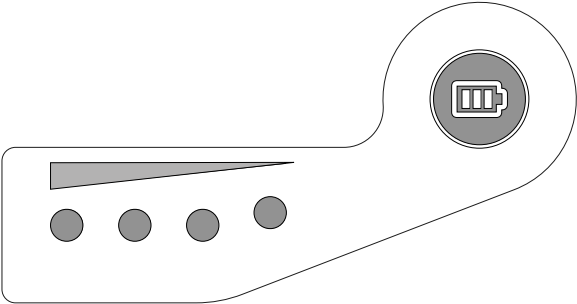

3.2 CAPACITY

INFORMATION

Capacity indicates the quantity of electric charge the battery can deliver or store. It is specified in ampere hours (Ah). Even when used properly, the capacity diminishes over time due to chemical reactions (ageing). Thus it reduces with every charging cycle, for example. The battery also ages slightly when it is not used.

Press the battery button.

The maximum available capacity of the battery will be displayed.

3.3. SLEEP MODE

INFORMATION

To prevent a total discharge, the battery management system (BMS) switches the battery to Sleep mode. Your battery reverts to Sleep mode after 48 hours (depending on charge level).

TO WAKE FROM SLEEP MODE

If the battery is in Sleep mode, you can wake it up again by pressing the battery button briefly.

4. CHARGING THE BATTERY

INFORMATION



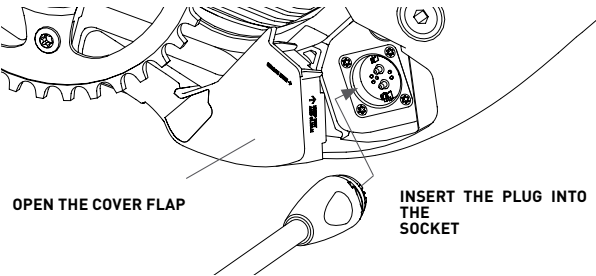

The battery can remain on the Pedelec during the charging process. It can also be removed and charged elsewhere.

- 1. Connect the power cable to the battery charger.
- 2. If you are charging the battery on the bicycle, now, slide the cover flap of the charging socket to the side. Then, insert the charging plug into the charging socket on the battery until it clicks into place.
- 3. Insert the mains plug into a power socket. The LED on the charger lights up red continuously. The battery charge level is displayed.



- 4. The charger switches off once the battery is fully charged. The LED on the charger lights up green continuously. The LEDs then go out.
- 5. After completing the charging process, remove the power plug from the socket.
- 6. Remove the charging cable from the battery charging socket.

4.1 BATTERY DISPLAY DURING CHARGING

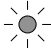
DISPLAY	DESCRIPTION	CHARGE LEVEL
	4 LEDs light up	80 – 100%
	3 LEDs light up	60 – 80%
	2 LEDs light up	40 – 60%
	1 LED lights up	20 – 40%
	1 LED flashes	0 – 20%

5. REMOVING AND INSERTING THE BATTERY

5.1 REMOVING THE BATTERY

1. Open the cover flap.

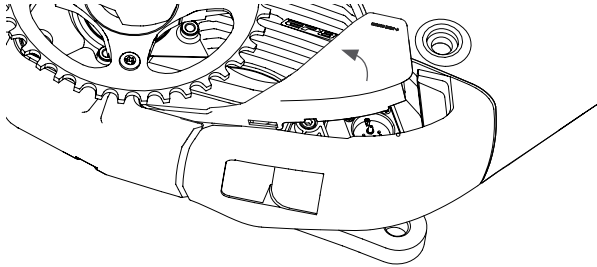

2. Hold the battery firmly from below. Turn the bolt counterclockwise with a 6mm Allen key and remove.

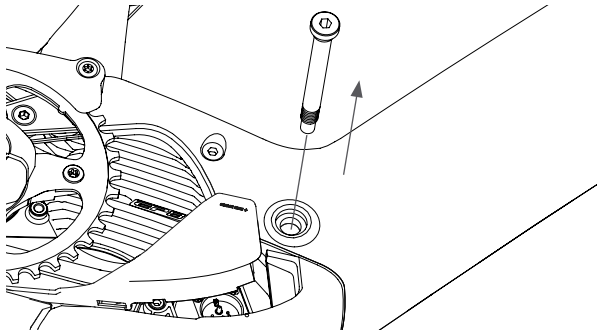

3. Remove the battery from the down tube.

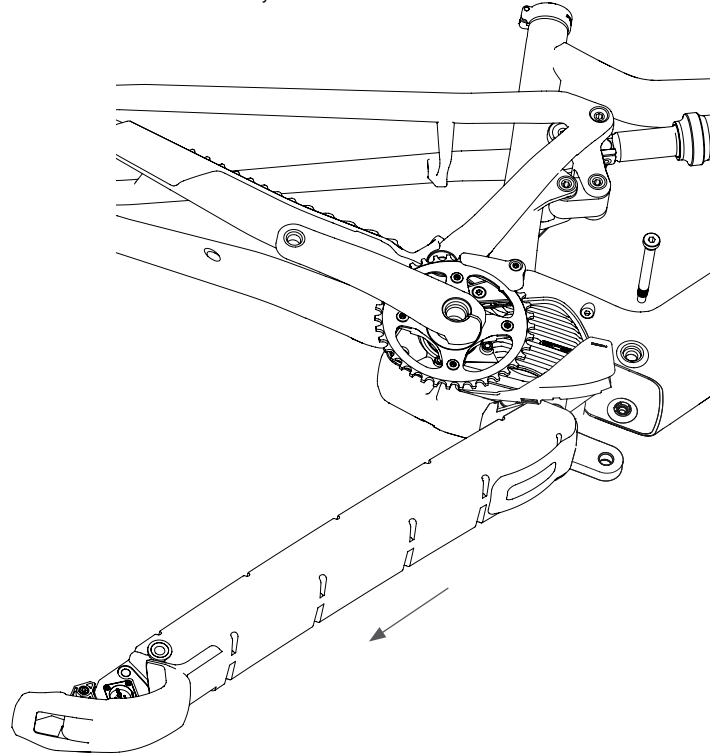

5. REMOVING AND INSERTING THE BATTERY

5.2 INSERTING THE BATTERY

1. Slide the battery into the down tube.

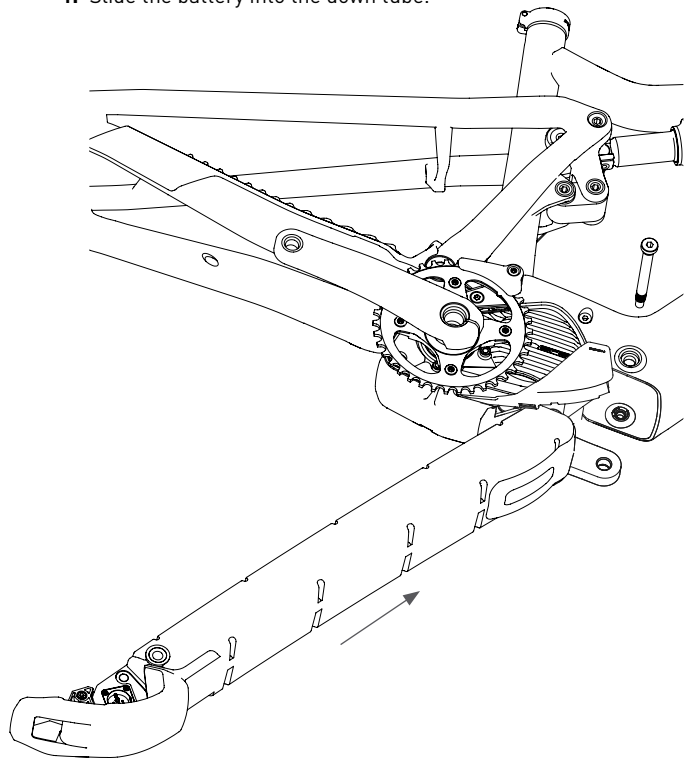

2. Insert the bolt into the opening and tighten clockwise to 6 Nm using a torque wrench (Allen key 6 mm).

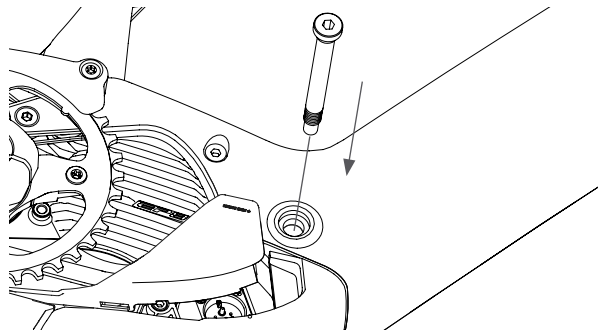

3. Close the cover flap.

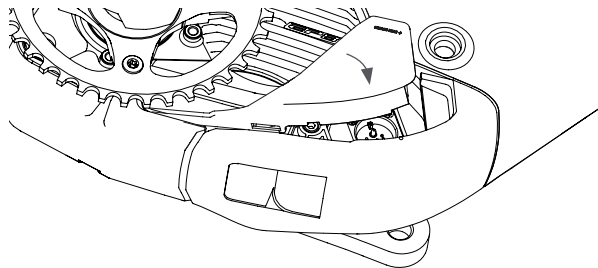

6. CLEANING

WARNING

SEVERE INJURY FROM ELECTRICAL SHOCK

Before cleaning the battery and/or charger, these must be disconnected from the mains power.

PLEASE NOTE

DAMAGE TO THE ELECTRONICS DUE TO WATER INGRESS.

Do not immerse the bicycle or its components in water, spray them with a water hose or clean them with a high-pressure washer. Damage may still result even though the components are sealed.

DAMAGED SURFACES DUE TO INCORRECT CLEANING.

Do not use any alcohol-, solvent-based or abrasive cleaners for cleaning. Similarly, coarse sponges or brushes must not be used.

6. 1 CLEANING THE BATTERY

WARNING

SERIOUS CRUSHING INJURY DUE TO ACCIDENTAL ACTUATION OF THE ON BUTTON.

Remove the battery before cleaning it.

1. Remove the battery from the Pedelec and from the charger.
2. Clean the housing with a slightly damp, soft cloth.
3. If the battery terminals are dirty, clean them with a dry, soft cloth.

6. 2 CLEANING THE CHARGER

1. Remove the charging cable from the battery charging socket.
2. Unplug the charger from the mains socket.
3. Clean the housing with a slightly damp, soft cloth.
4. If the terminals are dirty, clean them with a dry, soft cloth.

7. STORAGE

7.1 STORING THE BATTERY

1. Remove the battery from the Pedelec.
2. Store the battery in a dry, not excessively warm room.
The storage temperature should be between 0°C and 20°C.
The battery should not be exposed to direct sun.

7.2 STORING THE CHARGER

Store the battery in a dry, not excessively warm room. The battery should not be exposed to direct sun.

8. FAULTS AND REMEDIES

8. 1 BATTERY

DESCRIPTION	CAUSE	REMEDY
The battery gets hot when charging	Excessively high ambient temperature	Immediately stop the charge process and allow the battery to cool. Then resume charging in a cooler environment. If the problem recurs, get in touch with your specialist workshop. The battery may have to be replaced.
	Battery is damaged	Damaged batteries must not be charged or used for any other purpose. Get in touch with your specialist workshop. The battery may need to be replaced.
The battery does not charge.	Ambient temperature too high or too low	You can charge the battery at ambient temperatures between 0°C and 40°C.
	Battery is damaged	Damaged batteries must not be charged or used for any other purpose. Get in touch with your specialist workshop. The battery may need to be replaced.
	Battery charger faulty	Have your charger checked out by your cycle dealer; it may need to be replaced.
Battery is damaged.	Accident or fall involving the Pedelec or the battery has been dropped.	Damaged batteries must not be charged or used for any other purpose. Get in touch with your specialist workshop. The battery may need to be replaced.

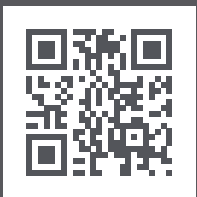

www.focus-bikes.com

FOCUS BIKES

Rotenwaldstraße 158
70197 Stuttgart
Germany

Legal Base:

Kalkhoff Werke GmbH
Europa-Allee 26
49685 Emstek
Germany

Telefon: +49 (0)4471 966-0
Telefax: +49 (0)4471.966-210

E-Mail: info@focus-bikes.com

Subject to misprints, errors and technical alterations.
1973K0023019