



Project _____
AIA # _____ SIS # _____
Item # _____ Quantity _____ C.S.I. Section 114000

G SERIES

1, 2 & 3 Section Display Freezers Self-Contained Hinged Glass Door(s)



Models listed to the applicable UL, CSA and NSF standards by an approved NRTL. Consult the factory or unit data plate for additional information.

AVAILABLE CONFIGURATIONS

Single Section Models

G13010M
G13011M

Hinging

Right
Left

Two Section Model

G23010M

Hinging

Left/Right

Three Section Models

G33010M
G33011M

Hinging

Left/Right/Right
Left/Left/Right

STANDARD PRODUCT FEATURES

- High Performance, Energy Efficient Refrigeration System Using R290
- Variable Speed Compressor (3 Section Only)
- Thermostatic Expansion Valve Metering Device Promotes Superior Temperature Recovery
- Perfect for Front-of-House Applications
- Reliable Microprocessor Control With LED Temperature Display
- Evaporator Coil Outside Food Zone Provides More Usable Space
- Load-Sure™ Guard Prevents Problems From Improper Loading
- Stainless Steel Front, Anodized Aluminum Sides & Interior
- Full Height Length Hinged Glass Doors With Locks
- Patented LED Display Door Illuminates without Adding Heat to the Interior
- Long Life EZ-Clean™ Door Gaskets
- (3) Epoxy Coated Shelves Per Section (factory installed)
- Easy to Maintain Front Facing Condenser Coil
- 6" High Locking Casters, (2) with Brakes / (2) without Brakes

FIELD INSTALLED ACCESSORIES & OPTIONS

- Trayslides for 18" x 26" Sheet Pans
- Trayslides for 12" x 20" Food Pans
- Trayslides for 14" x 18" Sheet Pans
- Set of (4) 4 1/8" Casters in Lieu of Standard
- Additional Shelves
- 6" High Legs

***Please refer to the G-Series Accessory Kit Guide for precise details. (Form TR35872)**

-GUARANTEED FOR LIFE CAM-LIFT HINGES

Approved by _____ Date _____ Approved by _____ Date _____

MODELS:

One Section Models: G13010M & G13011M

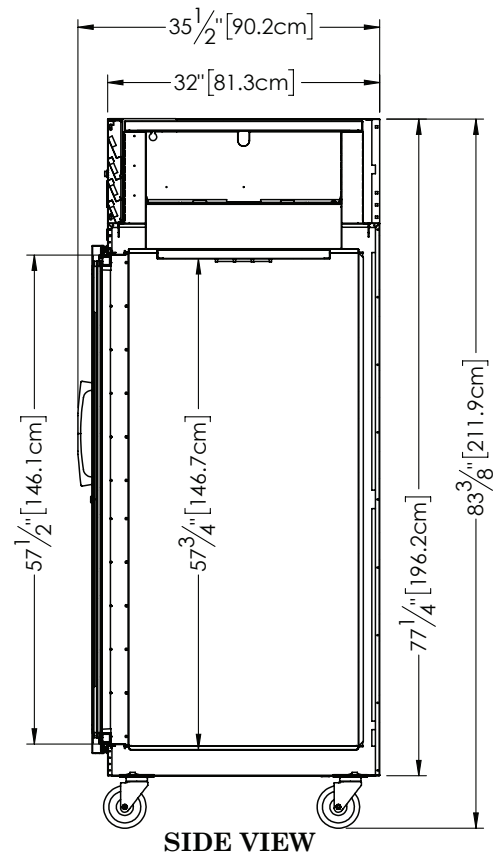
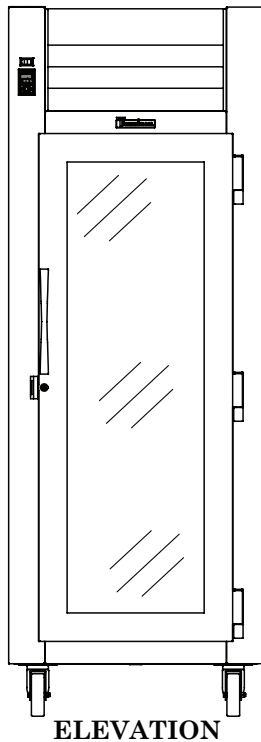
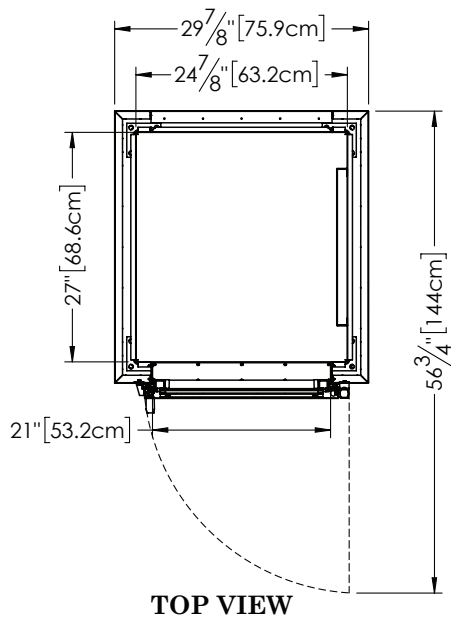

G SERIES

1, 2 & 3 Section Display Freezers Self-Contained Hinged Glass Door(s)

CAD and/or Revit Files Available

<https://traulsen.kclcad.com/>

MODELS:

Two Section Model: G23010M

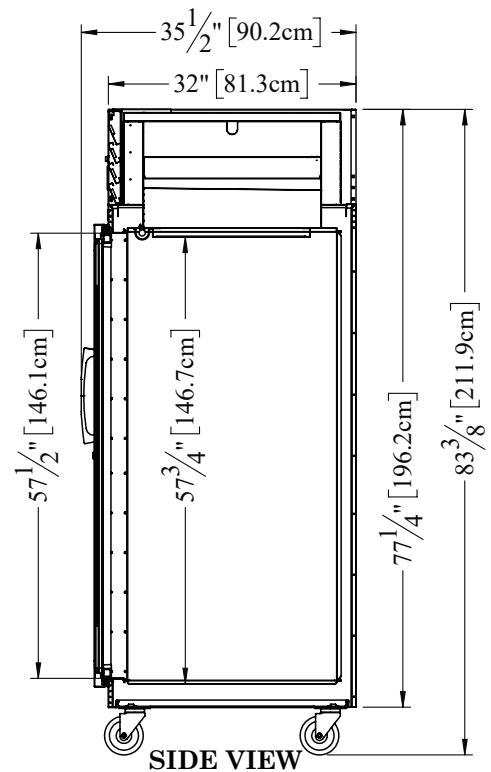
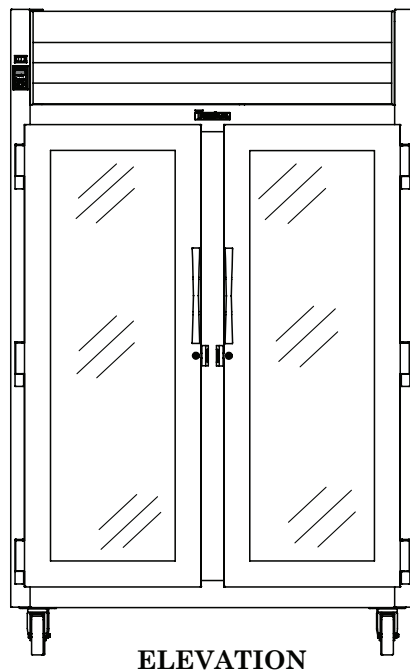
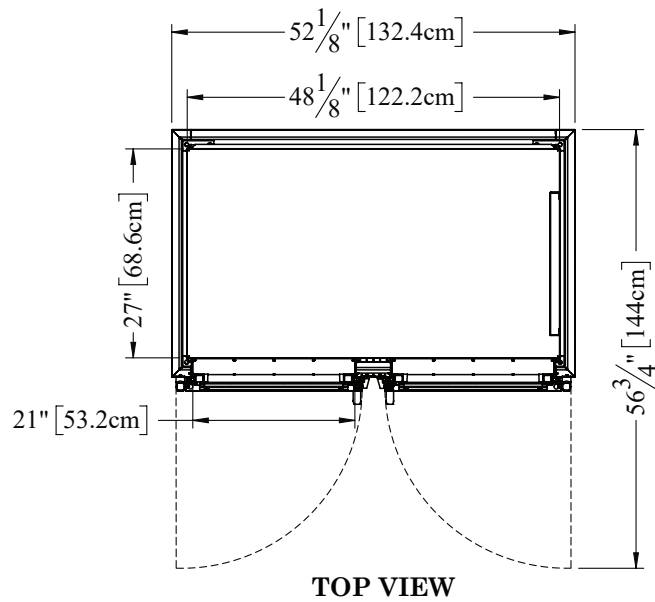



G SERIES

3 Section Display Freezers

Self-Contained Hinged Glass Door(s)

MODELS:

Three Section Models: G33010M & G33011M

CAD and/or Revit Files Available

<https://traulsen.kclcad.com/>

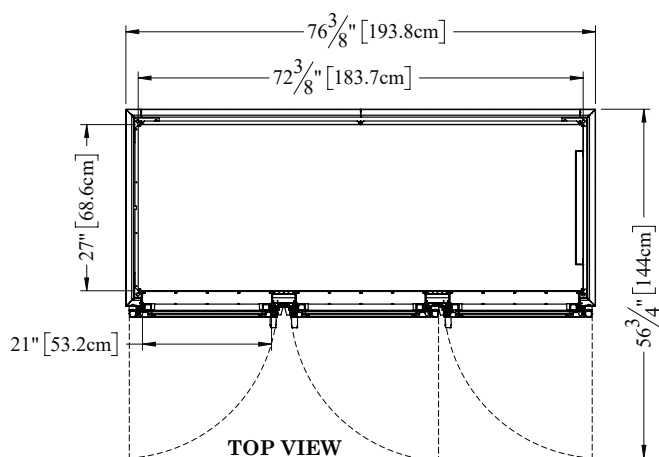

TOP VIEW

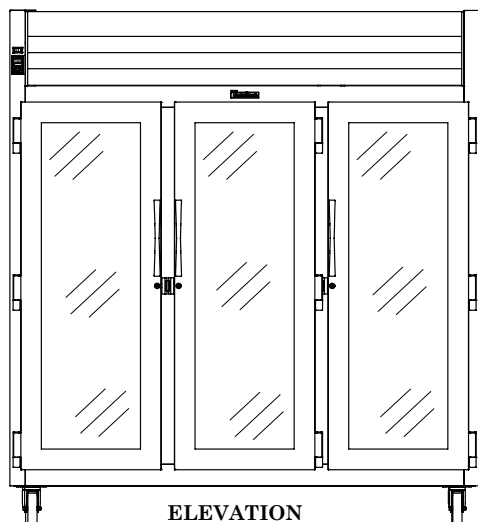

ELEVATION

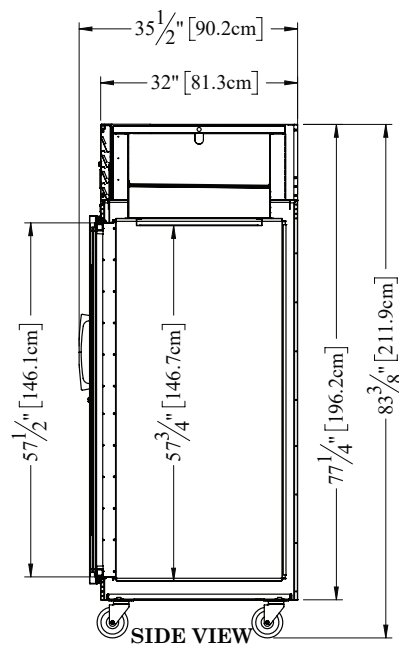

SIDE VIEW



G SERIES

1, 2 & 3 Section Display Freezers

Self-Contained Hinged Glass Door(s)

One Section Models: G13010M & G13011M
Two Section Model: G23010M
Three Section Models: G33010M & G33011M

EQUIPMENT SPECIFICATIONS

MODELS	G1301_M G23010M G3301_M
DIMENSIONAL DATA	
Net Capacity cu. ft.	23.57 (667l) 46.90 (1328 l) 70.67 (2001 l)
G1301_M L x D x H in.	29 ⁷ / ₈ " [75.9 cm] x 35 ⁷ / ₈ " [89.9 cm] x 83 ⁷ / ₈ " [211.9 cm]
G23010M L x D x H in.	52 ⁵ / ₈ " [132.4 cm] x 35 ⁷ / ₈ " [89.9 cm] x 83 ⁷ / ₈ " [211.9 cm]
G3301_M L x D x H in.	76 ⁵ / ₈ " [193.8 cm] x 35 ⁷ / ₈ " [89.9 cm] x 83 ⁷ / ₈ " [211.9 cm]
Depth - over body in.	32" [81.3 cm]
Depth - door open 90° in.	56 ¹ / ₂ " [144 cm]
Clear door width in.	21" [53.2 cm]
Clear full-height door in.	57 ¹ / ₂ " [146 cm]
No. Standard Shelves	3 6 9
Shelf Area sq. ft. ²	18.8 (1.75sq m) 34.6 (3.21sq m) 51.9 (4.82sq m)
ELECTRICAL DATA	
Voltage Plug (1 & 2 Section)	115/60/1 NEMA 5-15P
Voltage Plug (3 Section)	115/60/1 NEMA 5-20P
Full Load Amperes kWh/24HR ³	6.8 / 7.44 8 / 15.72 13.5 / 22.27
REFRIGERATION DATA	
Refrigerant	R290
Refrigerant Charge oz.	3.5 (99 g) 5.2 (147.4 g) 4.5 (127.6 g)
BTU/HR H.P. ⁴	2200 / 1/2 2900 / 1/2 3045 / 1-1/4
SHIPPING DATA	
G1301_M L x D x H Crated in. ¹	48" [122 cm] x 42" [107 cm] x 85" [216 cm]
G23010M L x D x H Crated in. ¹	62" [158 cm] x 42" [107 cm] x 85" [216 cm]
G3301_M L x D x H Crated in. ¹	91" [231 cm] x 42" [107 cm] x 85" [216 cm]
Volume Crated cu. ft.	71 133 188
Weight - Crated lbs.	355 510 630

NOTES:

- 12" Top clearance preferred for optimum performance & service access.
- Figure shown reflects the area of standard shelf complement
- kWh/24HR = Kilowatt usage per 24 hours
- Based on a 90°F ambient and -20°F evaporator

CONSTRUCTION, HARDWARE, INSULATION

Cabinet exterior front and louver assembly are constructed of heavy gauge stainless steel. Cabinet sides (including returns) and interior are constructed of anodized aluminum. The exterior cabinet top, back and bottom are constructed of heavy gauge galvanized steel. A set of four (4) 6" high casters are included.

Patented door design includes built-in LED display lights, removable plug cylinder locks and guaranteed for life cam-lift, gravity action, self-closing metal, glide hinges with stay open feature. Each door includes a vertically mounted stainless steel handle.

Gasket profile and durable long life material simplify cleaning and increase overall gasket life. Anti condensate heaters are located behind each door opening. The cabinet is insulated with an average of 2" thick high density, non-CFC, foamed in place polyurethane.

SELF-CONTAINED REFRIGERATION SYSTEM

A top mounted, self-contained, balanced refrigeration system using environmentally-friendly, low GWP R290 refrigerant is conveniently located behind the one piece louver assembly. It features an easy to clean front facing condenser, thermostatic expansion valve, air-cooled hermetic compressor, large, high humidity evaporator coil located outside the food zone and a top mounted non-electric condensate evaporator. A 9' (2.7m) cord and plug is provided. Standard operating temperature is 0 to -5°F (-18 to -20°C) and can be adjusted to operate as low as -10°F in a 90°F or less ambient..

CONTROL

The easy to use water resistant microprocessor control system is supplied standard. It includes a 3-Digit LED Display, and a Fahrenheit or Celsius Temperature Scale Display Capability.

INTERIOR ARRANGEMENTS

Standard interior arrangements include three (3) epoxy coated steel wire shelves, mounted on shelf pins, installed at the factory. Recommended load limit per shelf should not exceed 225 lbs.

DOMESTIC WARRANTY

Both a six year parts and labor warranty and an additional one year compressor parts warranty (for a total of seven on self-contained models) are provided standard.

When ordering please specify: Voltage, Hinging, and Options.

Equipped with one NEMA 5-15P Plug (1 & 2 section)



NEMA 5-20P Plug (3 section)



OPTIONAL ACCESSORY TRAYSLIDE VERSATILITY CHART

TRAYSLIDE DRAWINGS						
TRAYSLIDE OFFERING	#1 (1) 18" x26" or (2) 14"x18"	#4 (Rod Type) (1) 18" x26"	Universal (1) 18" x26" or (2) 14"x18" or (2) 12"x20"	#1 EZ-Change (1) 18" x26" or (2) 14"x18"	Universal EZ-Change (1) 18" x26" or (2) 14"x18" or (2) 12"x20"	HD Universal EZ-Change (1) 18" x26" or (2) 14"x18" or (2) 12"x20"
SPACING CAPACITY DOOR SIZE	2" 28 Pairs Full Door 3" 19 Pairs Full Door 4" 14 Pairs Full Door 5" 11 Pairs Full Door	1 1/2" 38 Pairs Full Door (2 Pair)	4" 14 Pairs Full Door 4" 14 Pairs Full Door 5" 11 Pairs Full Door 6" 09 Pairs Full Door	2" 26 Pairs Full Door 4" 13 Pairs Full Door	2 1/4" 22 Pairs Full Door 4 1/2" 11 Pairs Full Door	4 1/2" 11 Pairs Full Door 9" 05 Pairs Full Door

CONTINUED PRODUCT DEVELOPMENT MAY NECESSITATE SPECIFICATION CHANGES WITHOUT NOTICE.